

FRONT WHEEL/SUSPENSION/STEERING

NC700XD:

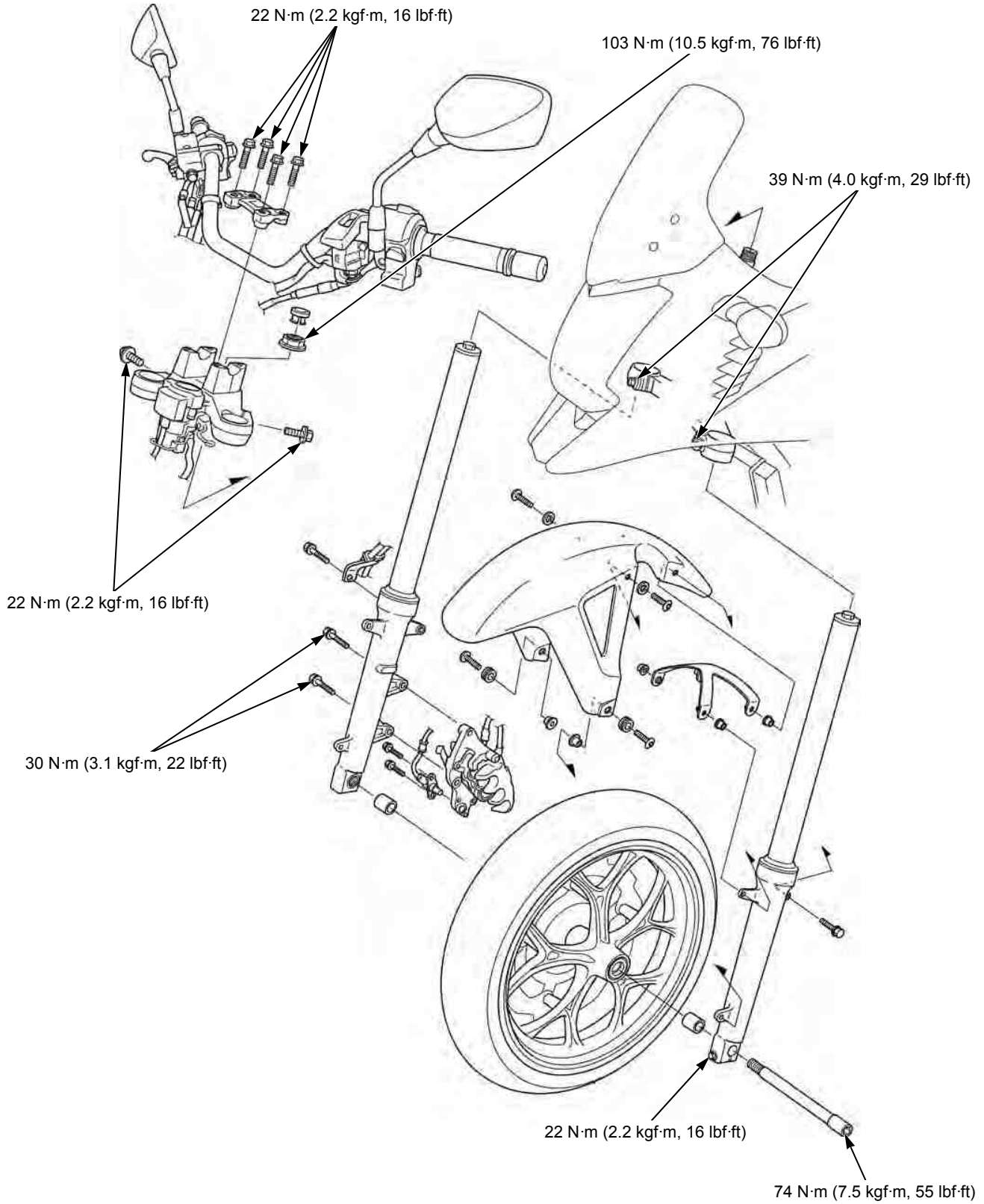

FRONT WHEEL/SUSPENSION/STEERING

INNER WEIGHT REPLACEMENT

Remove the throttle pipe or grip rubber from the handlebar.

- NC700X/XA/S/SA (page 17-10)
- NC700XD/SD (page 17-12)

Straighten the retainer ring tab [1] by the screwdriver or punch.

Apply lubricant spray through the tab locking hole [4] to the rubber cushions [5] for easy removal.

Temporarily install the handlebar weight [2] and screw, then remove the inner weight assembly [3] by turning the handlebar weight.

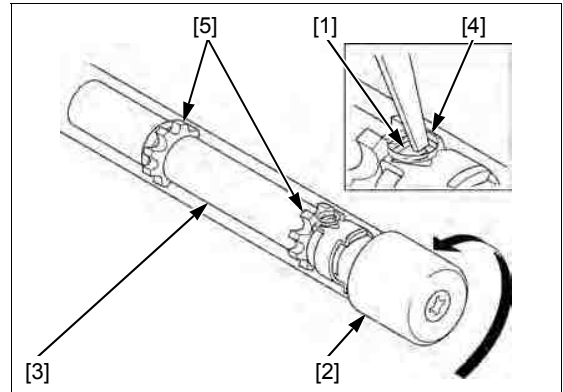

Remove the screw [1], handlebar weight [2], retainer ring [3] and rubber cushions [4] from the inner weight [5].

Install the rubber cushions and new retainer ring onto the inner weight.

Install the handlebar weight to the inner weight align with each cut-outs of the inner weight and handlebar weight.

Install and tighten the handlebar weight screw.

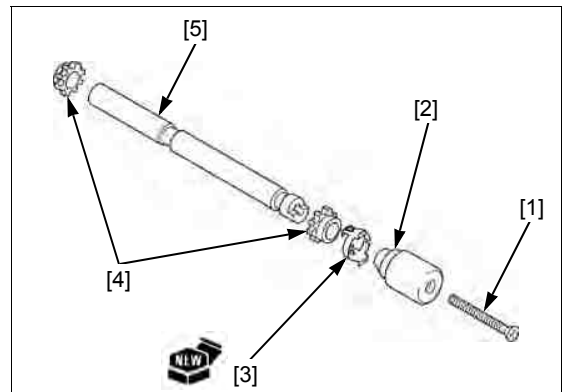

Install the inner weight assembly [1] into the handlebar. Turn the inner weight and hook the weight retainer tab [2] with the tab locking hole [3] in the handlebar.

Remove the screw and handlebar weight.

Install the throttle pipe and grip rubber to the handlebar.

- NC700X/XA/S/SA (page 17-14)
- NC700XD/SD (page 17-17)

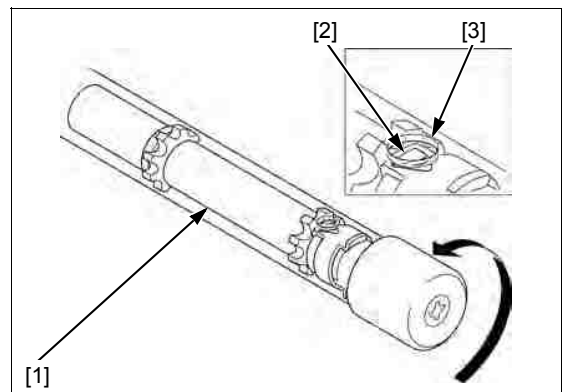

FRONT WHEEL

REMOVAL

NC700X/S: Remove the front brake caliper mounting bolts [1] and slide the brake caliper/bracket assembly [2].

NOTE:

Do not suspend the brake caliper/bracket assembly from the brake hose. Do not twist the brake hose.

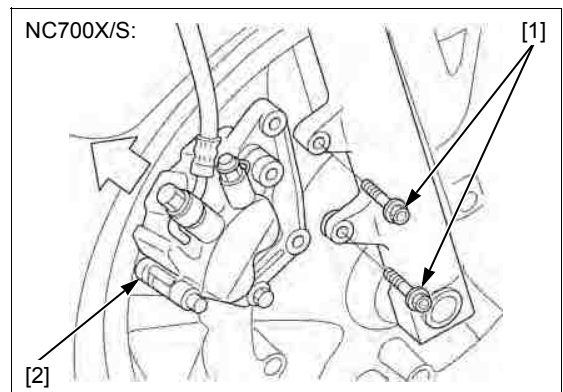

FRONT WHEEL/SUSPENSION/STEERING

NC700XA/XD/SA/ Remove the brake pads (page 19-17).

SD: Remove the bolts [1] and front wheel speed sensor [2] from the caliper bracket.

Check that there is no iron or other magnetic deposits between the pulser ring and front wheel speed sensor. Remove any deposits.

Check the sensor tip for deformation or damage (e.g., chipped pulser ring teeth). Replace the front wheel speed sensor if necessary (page 20-25).

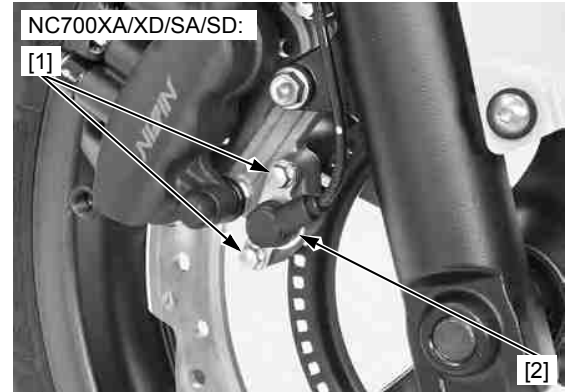

Loosen the front axle pinch bolt [1] and front axle [2].

Support the motorcycle using a safety stand or hoist, raise the front wheel off the ground.

Remove the front axle and front wheel.

NOTE:

Do not operate the brake lever after removing the front wheel.



Remove the side collars [1].

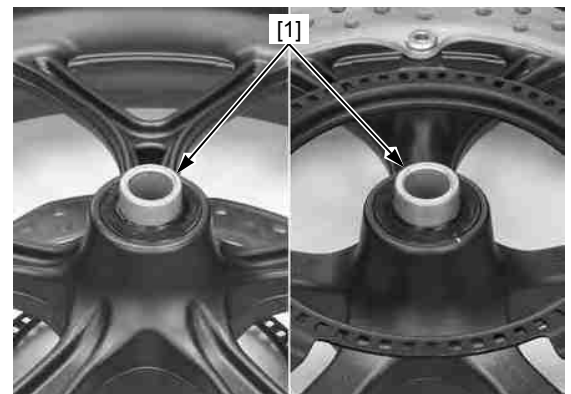

INSPECTION

WHEEL RIM

Check the wheel rim runout by placing the wheel in a truing stand.

Spin the wheel by hand and measure the runout using a dial indicator.

SERVICE LIMITS:

Radial: 2.0 mm (0.08 in)

Axial: 2.0 mm (0.08 in)

AXLE

Place the axle on V-blocks.

Turn the axle and measure the runout using a dial indicator.

Actual runout is 1/2 of the total indicator reading.

SERVICE LIMIT: 0.2 mm (0.01 in)

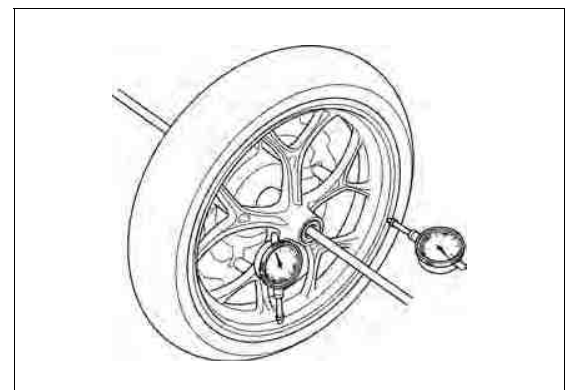

FRONT WHEEL/SUSPENSION/STEERING

WHEEL BEARING REPLACEMENT

Install the bearing remover head [1] into the bearing [2]. From the opposite side, install the bearing remover shaft [3] and drive out the bearing from the wheel hub.

Remove the distance collar and drive out the other bearing.

TOOLS:

Bearing remover head, 20 mm 07746-0050600
Bearing remover shaft 07GGD-0010100

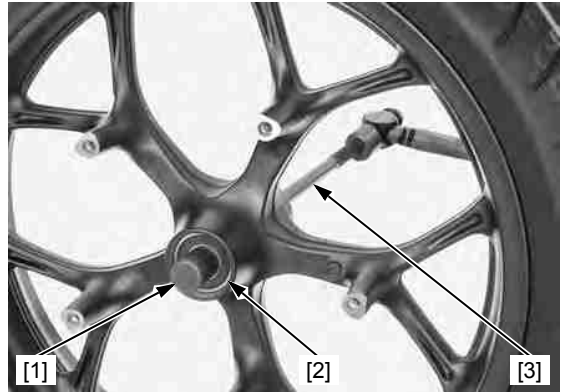

Never install the old bearing, once the bearing has been removed, the bearing must be replaced with new ones.

Drive in a new right side bearing [1] squarely with its marked side facing up until it is fully seated.

Install the distance collar.

Drive in a new left side bearing squarely with its marked side facing up until it is seated on the distance collar.

TOOLS:

Driver [2] 07749-0010000
Attachment, 42 x 47 mm [3] 07746-0010300
Pilot, 20 mm [4] 07746-0040500

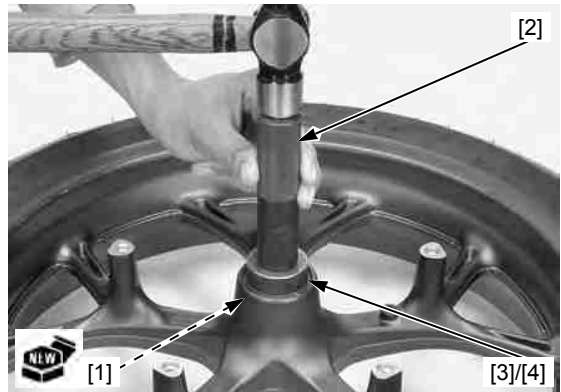

INSTALLATION

Install the side collars [1].

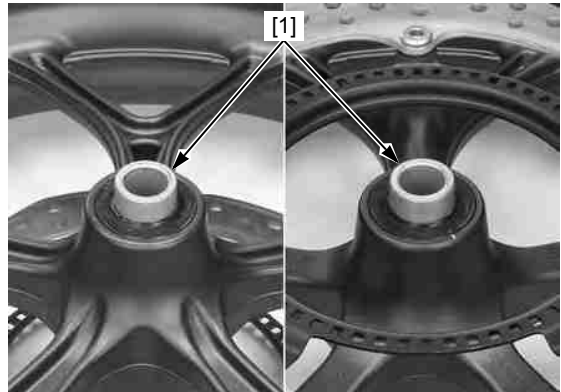

Install the front wheel between the fork legs.

Apply a thin coat of grease to the front axle sliding surface.

Install the front axle [1] from left side.

Tighten the front axle to the specified torque.

TORQUE: 74 N·m (7.5 kgf·m, 55 lbf·ft)



FRONT WHEEL/SUSPENSION/STEERING

- NC700XA/XD/SA/SD: Install the front wheel speed sensor [1] and bolts [2]. Tighten the bolts securely.
- Check the air gap between the front wheel speed sensor and pulser ring (page 20-24).
- Install the brake pads (page 19-17).

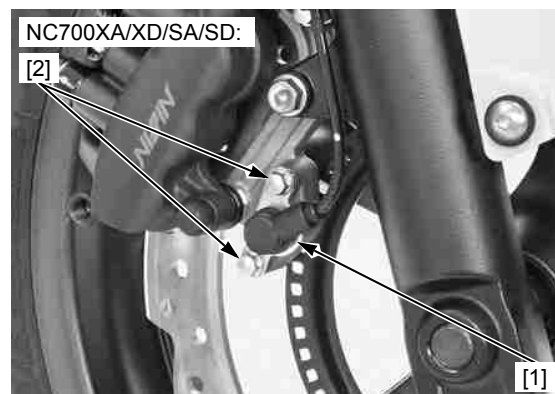

- NC700X/S: Install the front brake caliper/bracket assembly [1] and tighten new brake caliper mounting bolts [2] to the specified torque.

TORQUE: 30 N·m (3.1 kgf·m, 22 lbf·ft)

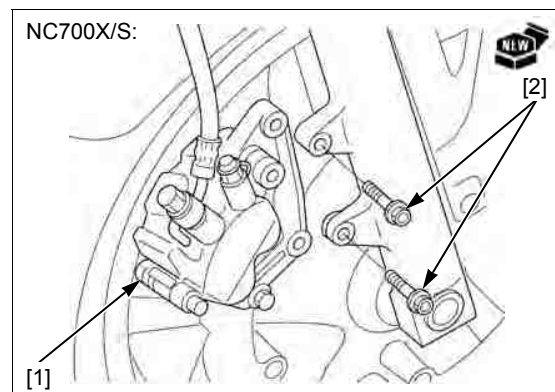

With the front brake applied, pump the forks up and down several times to seat the axle and check brake operation.

Tighten the front axle pinch bolt [1] to the specified torque.

TORQUE: 22 N·m (2.2 kgf·m, 16 lbf·ft)



FORK

REMOVAL

Remove the following:

- Front wheel (page 17-20)
- Front fender (page 2-28)

Do not suspend the brake caliper/bracket assembly from the brake hose. Do not twist the brake hose.

Remove the brake caliper mounting bolts [1] and brake caliper/bracket assembly [2].

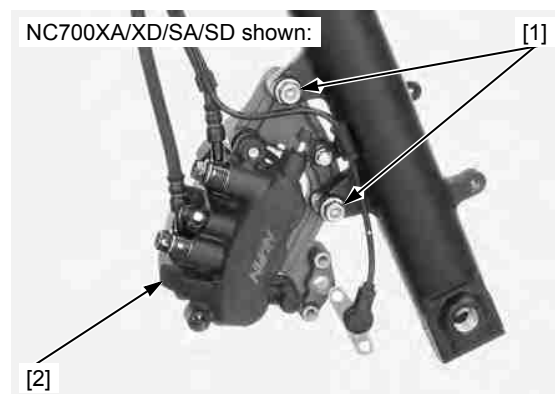

REAR WHEEL/SUSPENSION

NC700XD/SD:

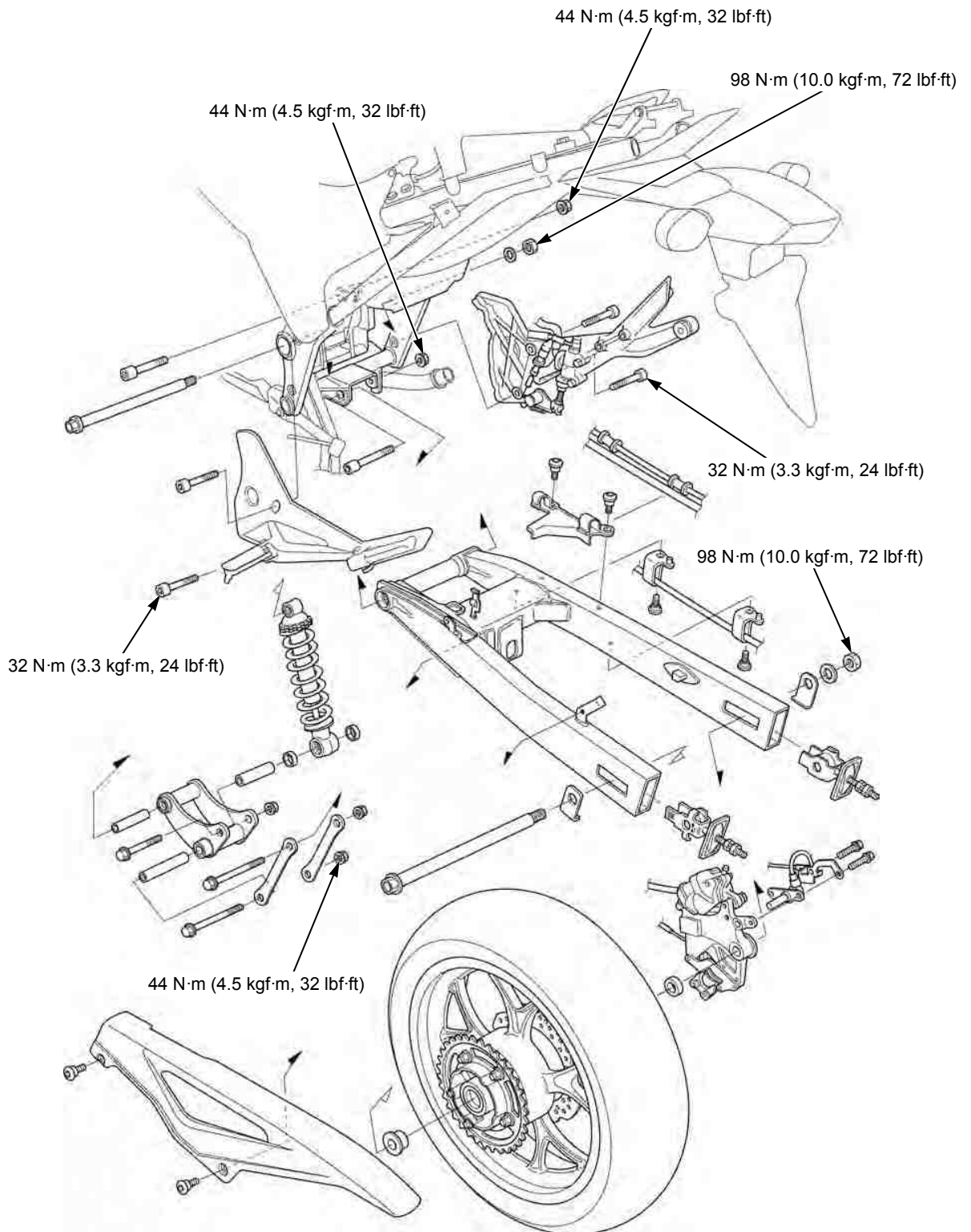

REAR WHEEL/SUSPENSION

REAR WHEEL

REMOVAL

Support the motorcycle using a safety stand or hoist, raise the rear wheel off the ground.

NC700XA/XD/SA/SD: Remove the bolts [1] and rear wheel speed sensor [2].

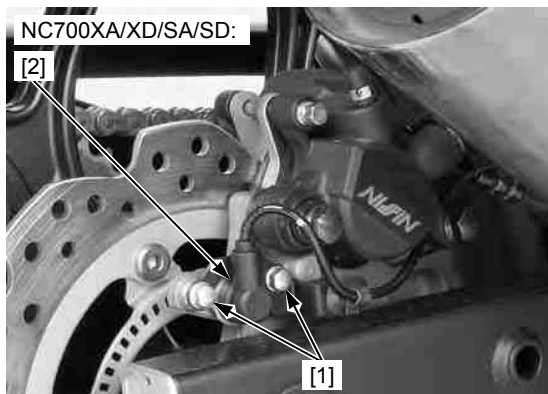

Loosen the lock nut [1], drive chain adjusting nut [2] and axle nut [3].

Push the rear wheel forward.

Derail the drive chain [4] from the driven sprocket.

Remove the axle nut, washer [5] and adjusting plate [6].

Do not operate the brake pedal after removing the rear wheel.

Remove the axle [7], adjusting plate and rear wheel.

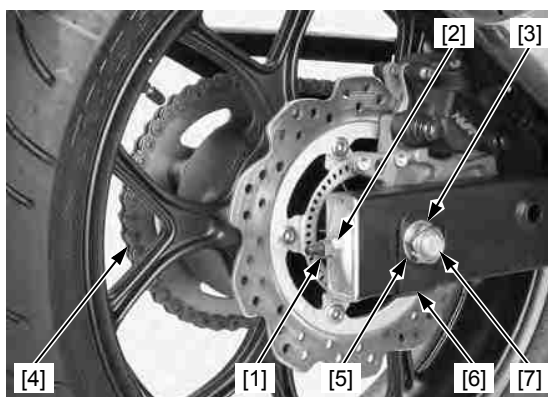

Remove the side collars [1].

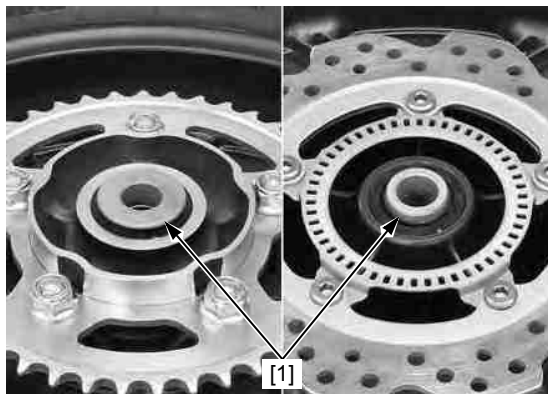

REAR WHEEL/SUSPENSION

Apply grease to a new O-ring [1].

Install the damper rubbers [2] and the O-ring into the left wheel hub.

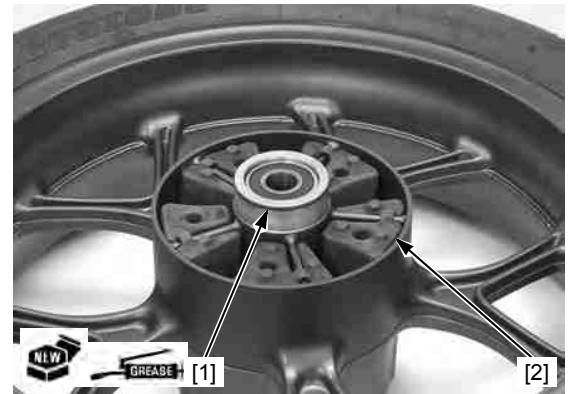

Install the driven flange assembly [1] into the left wheel hub.

Tighten the driven sprocket nuts [2] to the specified torque in a crisscross pattern in 2 or 3 steps.

TORQUE: 108 N·m (11.0 kgf·m, 80 lbf·ft)

Apply grease to a new dust seal lips.

Install the dust seal [3] to the driven flange.



Install the pulser ring (NC700XA/XD/SA/SD) [1] onto right wheel hub.

Install the rear brake disc [2] with its arrow mark [3] facing out.

Install and tighten new brake disc bolts [4] to the specified torque in a crisscross pattern in 2 or 3 steps.

TORQUE: 42 N·m (4.3 kgf·m, 31 lbf·ft)

Apply grease to a new dust seal lips.

Install the dust seal [5] to the right wheel hub.

NOTE:

Do not get grease on the brake disc.

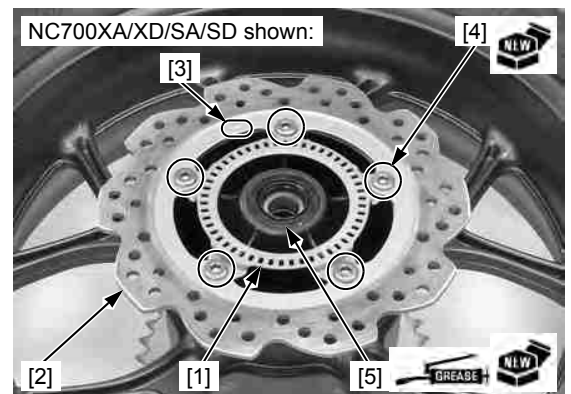

INSTALLATION

Install the right side collar [1] and left side collar [2].

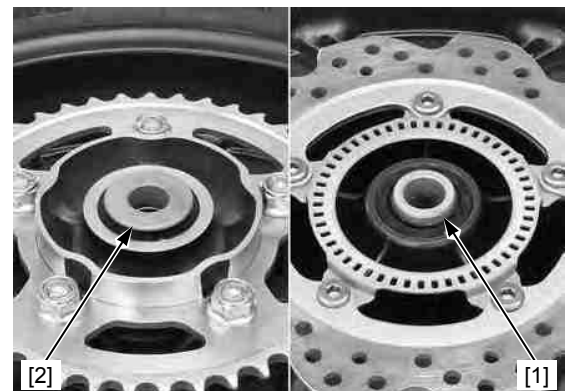

REAR WHEEL/SUSPENSION

Install the brake caliper/bracket assembly [1] to the swingarm.

NOTE:

Align the bracket groove with swingarm tab.

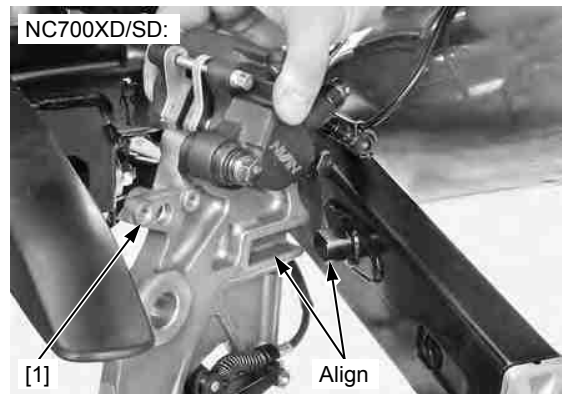
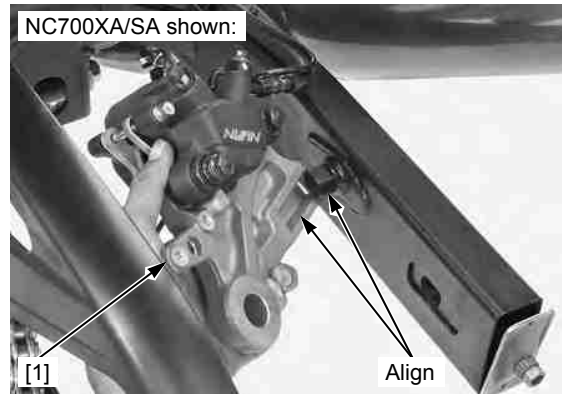

Be careful not to damage the brake pads.

Install the rear wheel in the swingarm aligning the brake disc between the brake pads.

Install the drive chain [1] over the driven sprocket.

Apply a thin coat of grease to the rear axle outer surface.

Install the rear axle [2] from the left side through the axle adjusting plate [3], swingarm, rear wheel and collars.

Install the adjusting plate, washer [4] and rear axle nut [5].

Tighten the rear axle nut to the specified torque.

TORQUE: 98 N·m (10.0 kgf·m, 72 lbf·ft)

Adjust the drive chain slack (page 3-16).

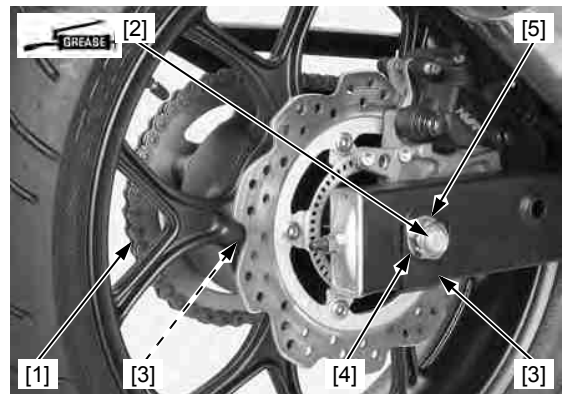

NC700XA/XD/SA/SD:

Install the rear wheel speed sensor [1] and bolts [2]. Tighten the bolts securely.

Check the air gap between the rear wheel speed sensor and pulser ring (page 20-24).

NC700XD/SD:

Check the parking brake lock operation (page 3-24).

