

19. Secure the heated grip harness as shown.

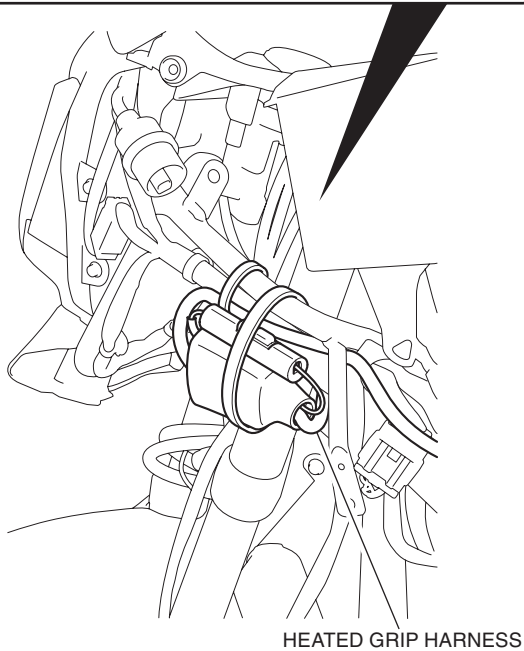

20. Remove the handlebar weight from the motorcycle as shown.

- Repeat on the left side.

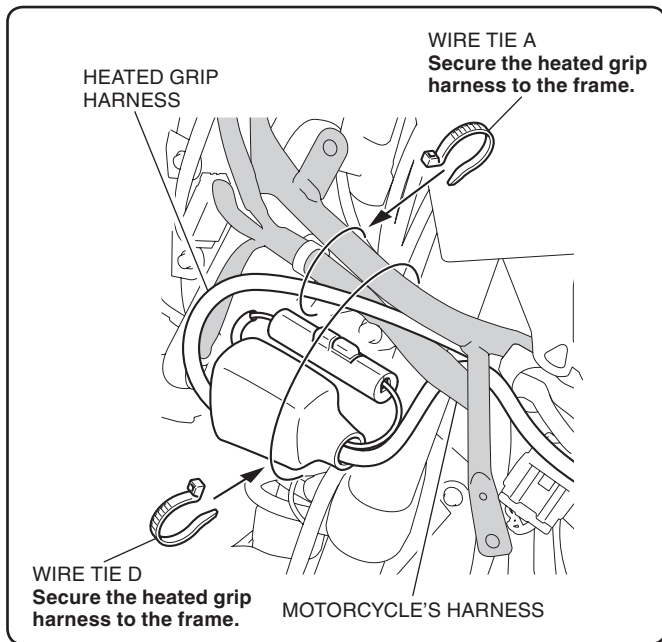
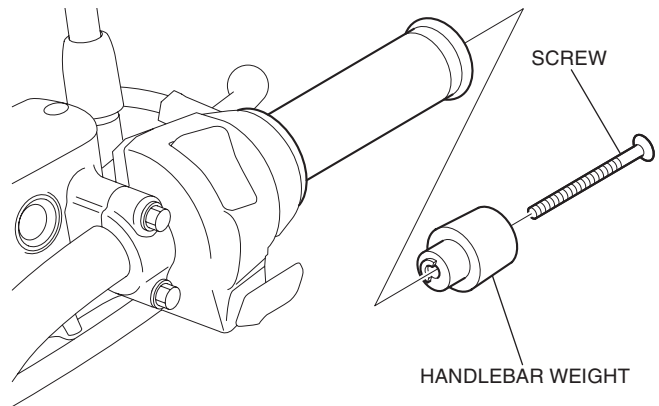

21. Loosen the bolts and slide the master cylinder to the left as shown.

- Be careful not to scratch the handlebar.

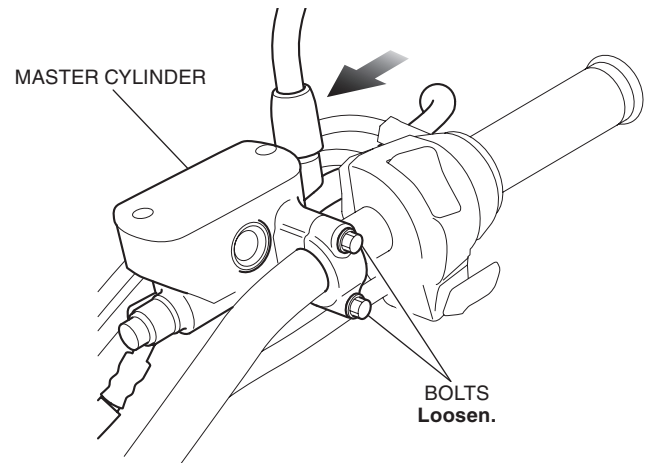

22. Remove the right handlebar switch as shown.

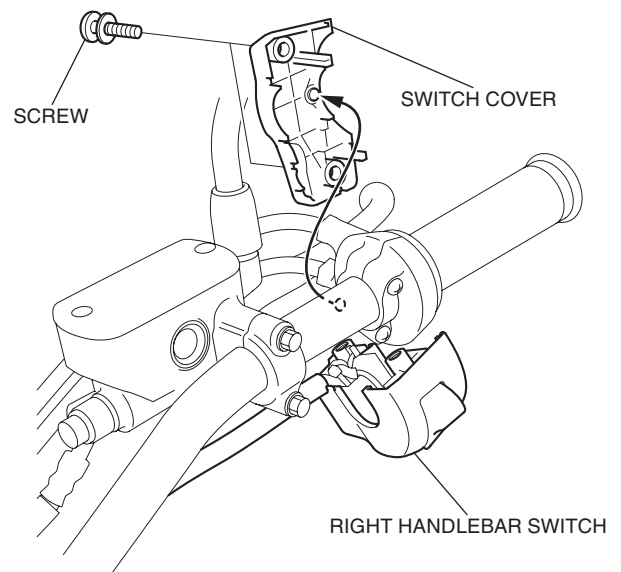

23. Remove the throttle housing cover as shown.

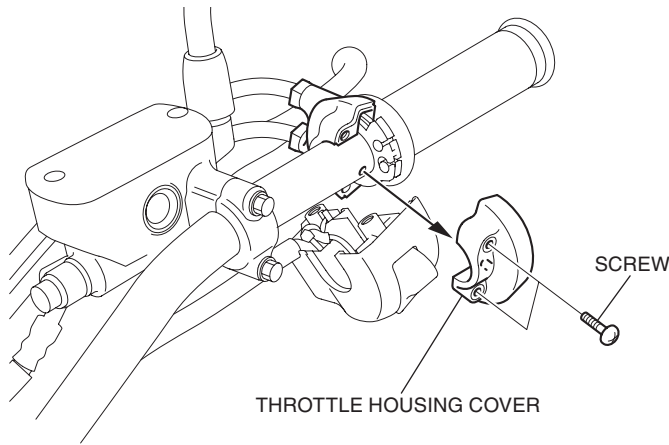

24. Remove the right grip as shown.

**NOTE**

Disconnect the throttle cable from the right grip as instructed in the motorcycle's Service Manual. Do not try to disconnect the cable with force using pliers, etc. Refer to the motorcycle's Service Manual.

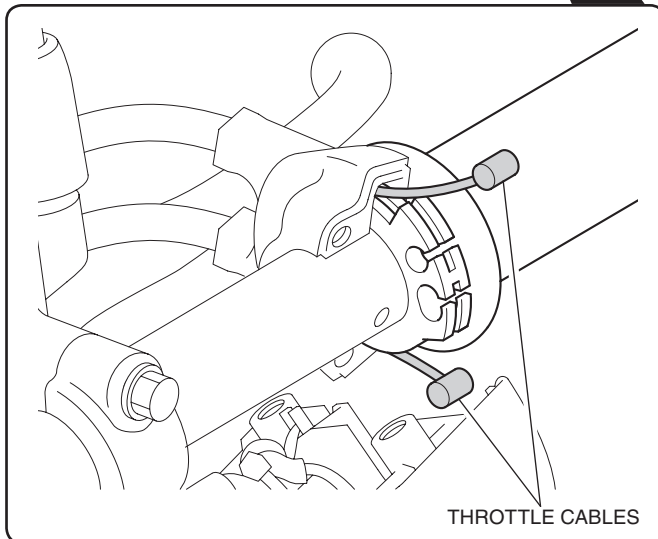
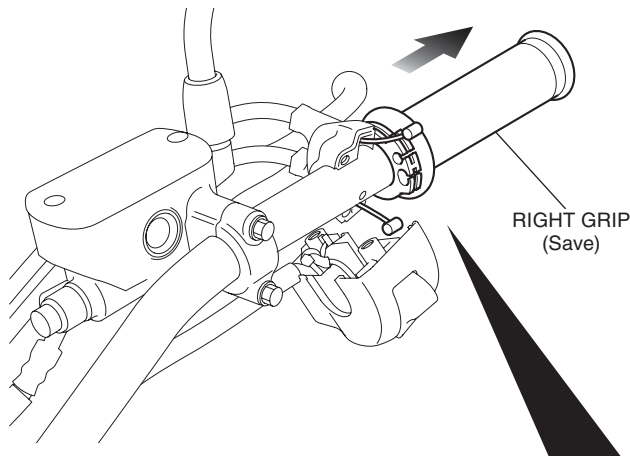

25. Mark the right heated grip harness in the position shown.

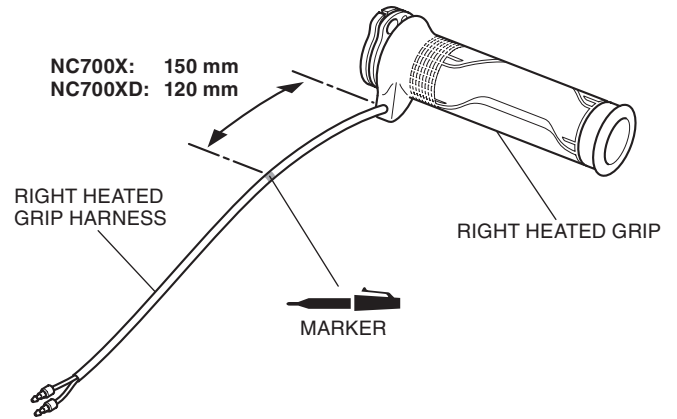

26. Apply grease to the  parts of the throttle cables and throttle pipe as shown.

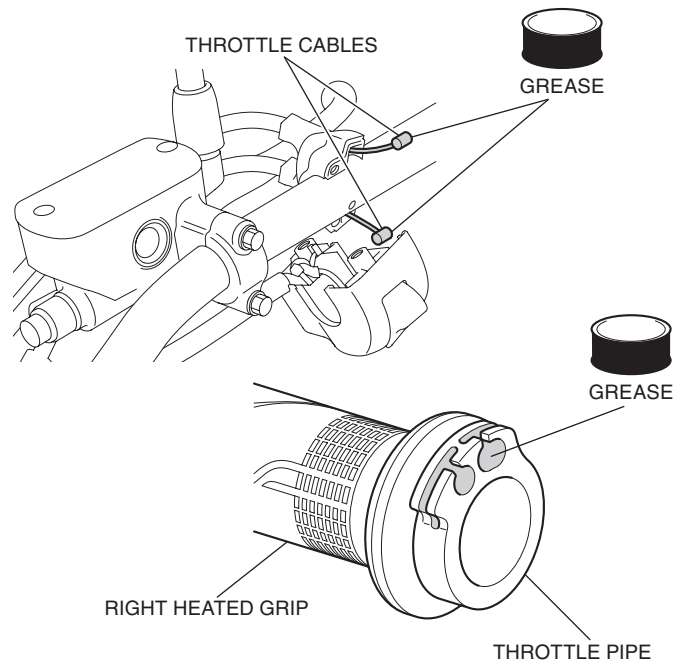

27. Install the right heated grip in the reverse order of the motorcycle's grip removal.

- After installation, refer to the Service Manual and adjust the throttle freeplay.

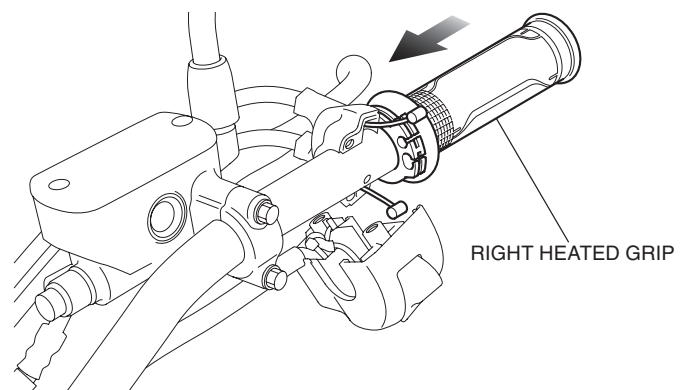

28. Reposition the master cylinder correctly and tighten the bolts as shown.

- **Be careful not to scratch the handlebar.**

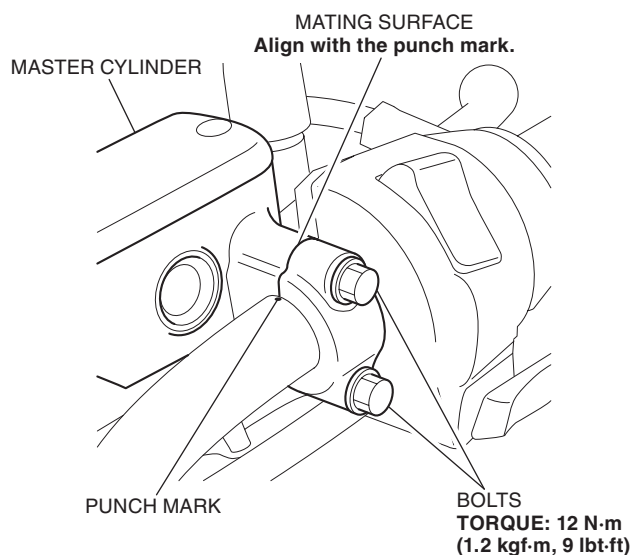

29. Reinstall the handlebar weight as shown.

- **Before applying thread lock, thoroughly clean the screw.**

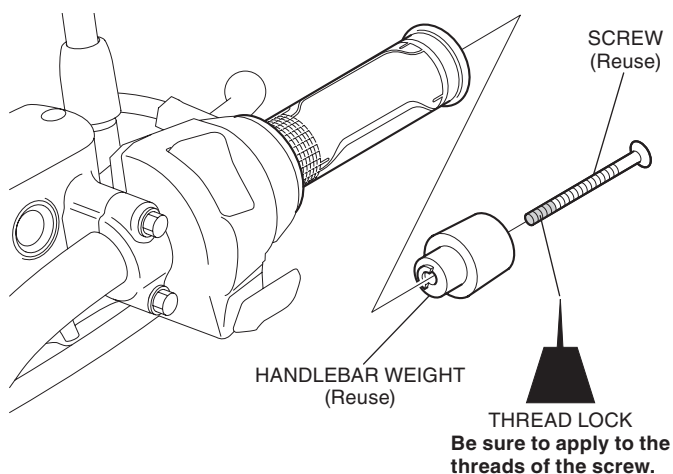

30. Twist the throttle grip as shown.

- **Check that the throttle opens and automatically closes smoothly.**

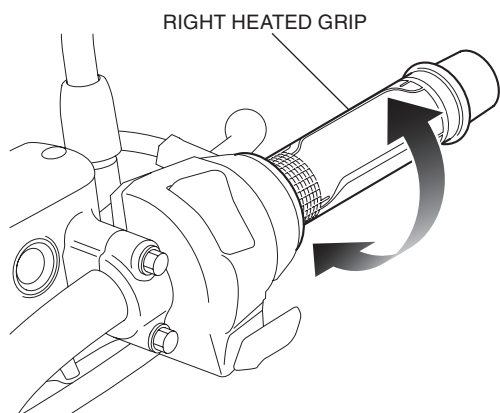

31. Remove the left grip as shown.

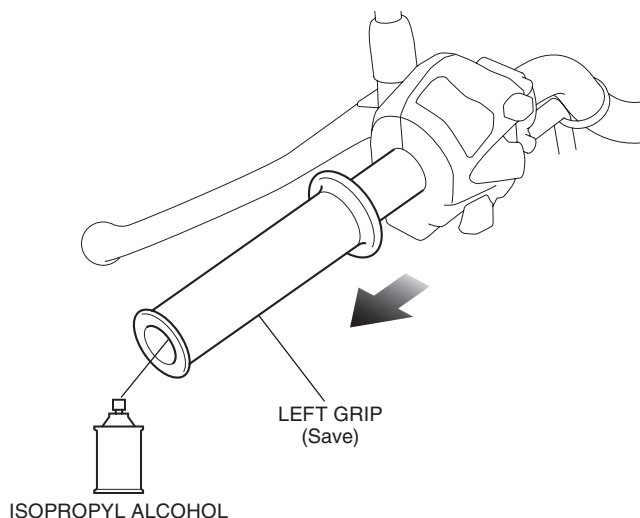

32. Using an isopropyl alcohol, remove all traces of adhesive from the left handlebar.

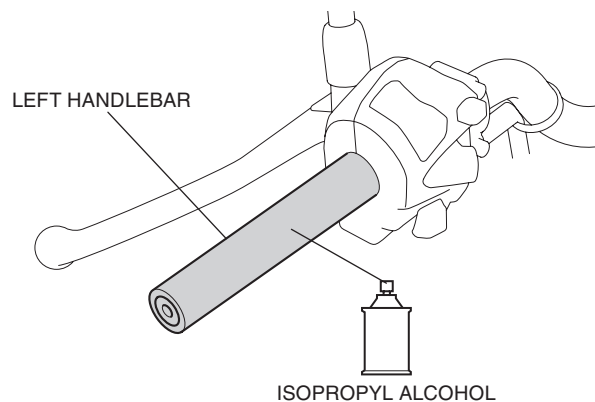

33. Liberally apply Pro Honda Handgrip Cement to the inside of the left heated grip from the kit as shown.

**NOTE**

Read the Instructions of the steps 33 through 36 carefully before installation and complete the operation quickly before the adhesive cures. Use an assistant to steady the motorcycle while installing the grip.

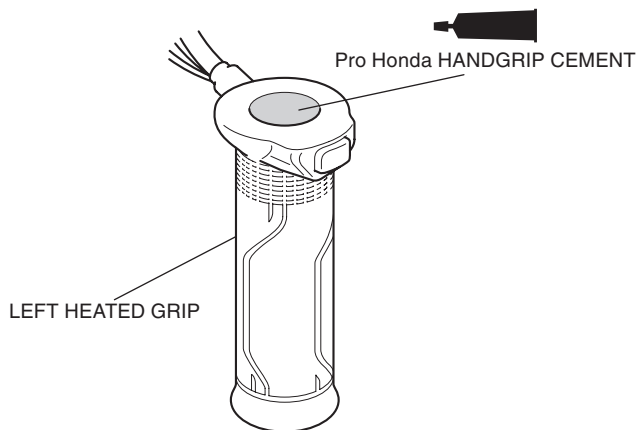

34. Apply Pro Honda Handgrip Cement to the left handlebar as shown.

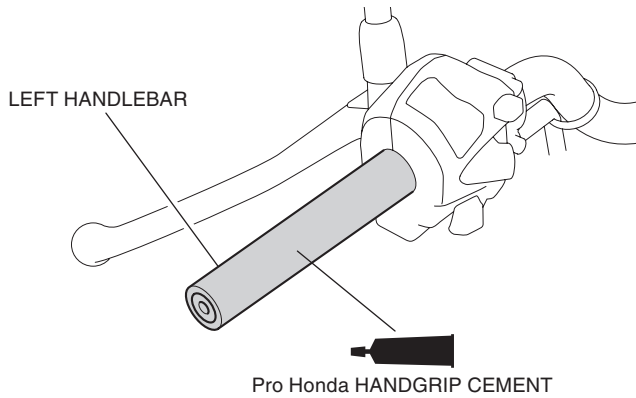

35. Spray isopropyl alcohol over the inside of the left heated grip and outside of the left handlebar.

- This is done to ease alignment between the heated grip and handlebar.

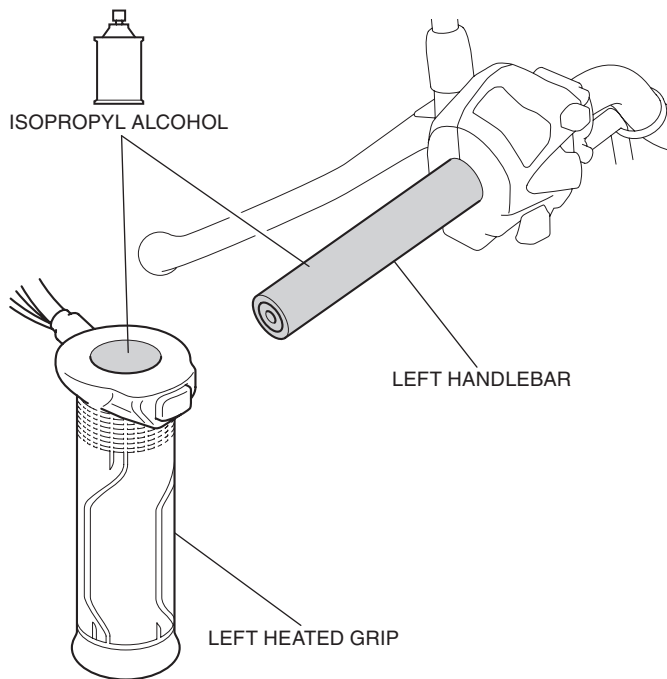

36. Slide the left heated grip onto the left handlebar as indicated.

- Wipe up excess adhesive at once.

**NOTICE**

- Do not tap on the grip end with a hammer and do not twist the grip with force to insert the left heated grip onto the handlebar, as it can damage the heated grip element.

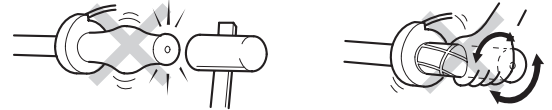

- Avoid putting pressure on the switch part when inserting the left heated grip. There is a possibility that the switch part will break. Also, install so that there is no gap with the left handlebar switch.



- If the grip gets stuck halfway during installation, apply isopropyl alcohol between the heated grip and handlebar. Do not try to remove the left heated grip using force or tools as the heated grip element can be damaged.

**<NC700X>**

Insert until there is contact with the left handlebar switch, then align with the indicated position.

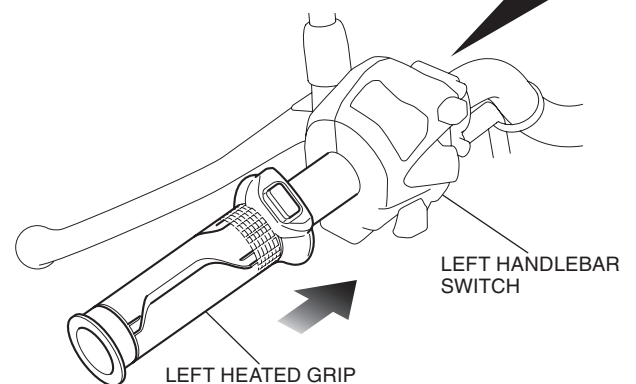
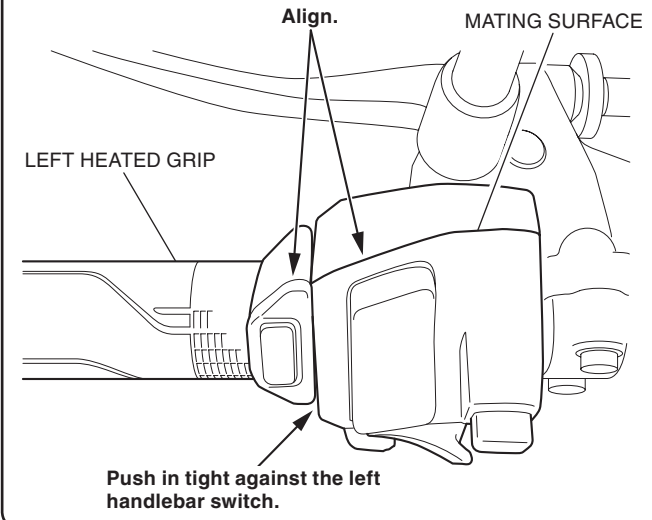

<NC700XD>

Insert until there is contact with the left handlebar switch, then align with the indicated position.

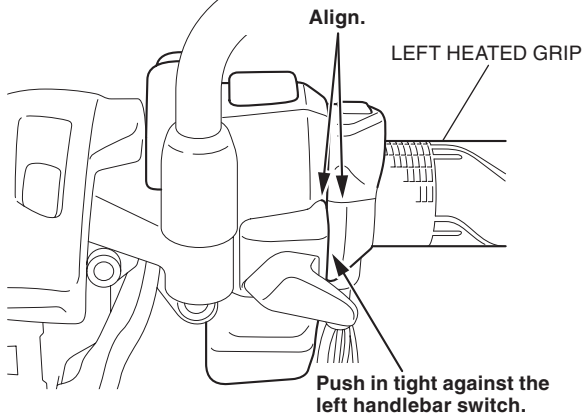

37. Reinstall the handlebar weight as shown.

- Before applying thread lock, thoroughly clean the screw.

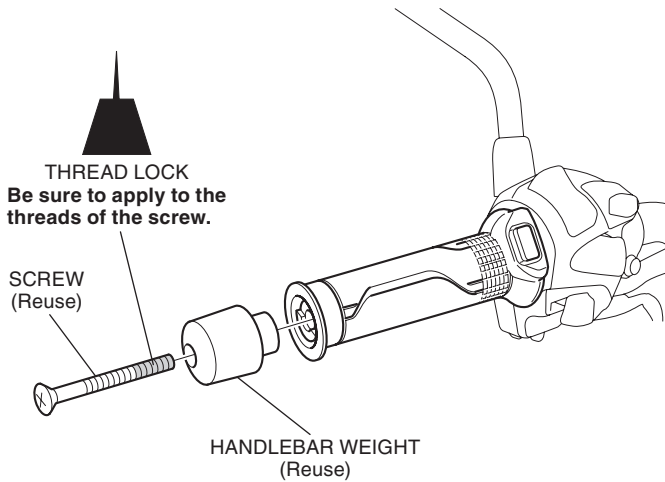

38. Route and secure the heated grip harness as shown.

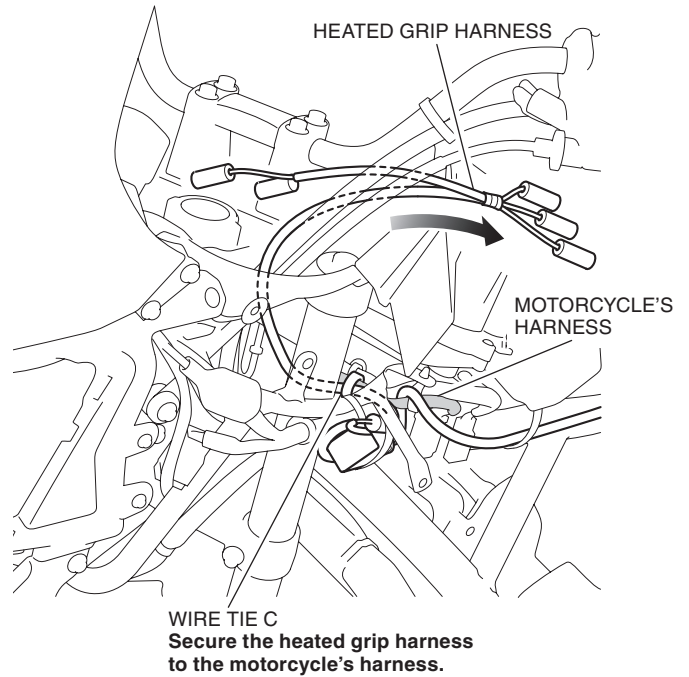

39. Connect the heated grip harness as shown.

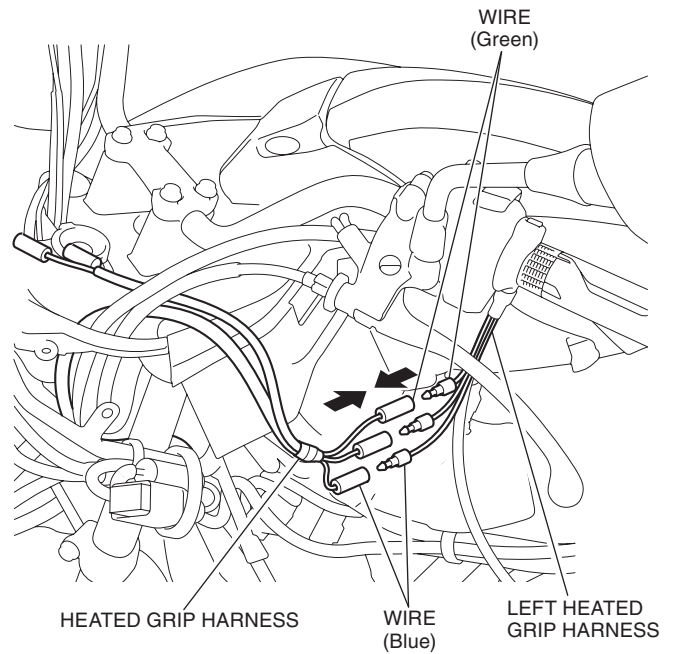

40. Wrap each harness with electrical tape as shown.

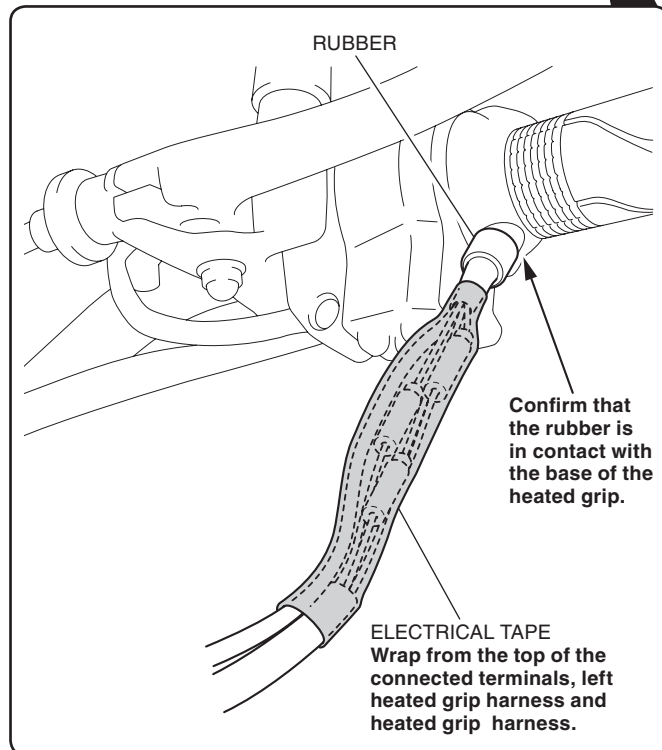
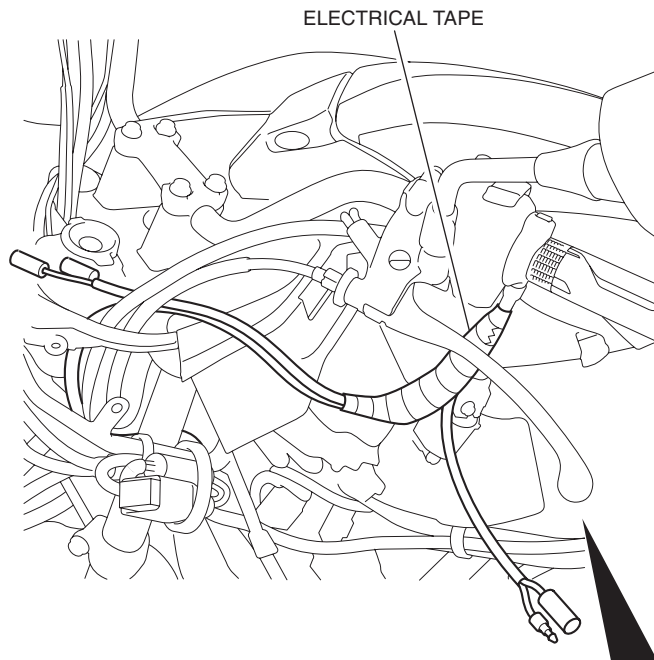

41. Secure each harness with the wire ties as shown.

- **Secure while the handlebar is turned right fully. After securing, move the handlebar right and left and check that the harnesses are not pinched by the neighboring components and that they are not pulled taut.**

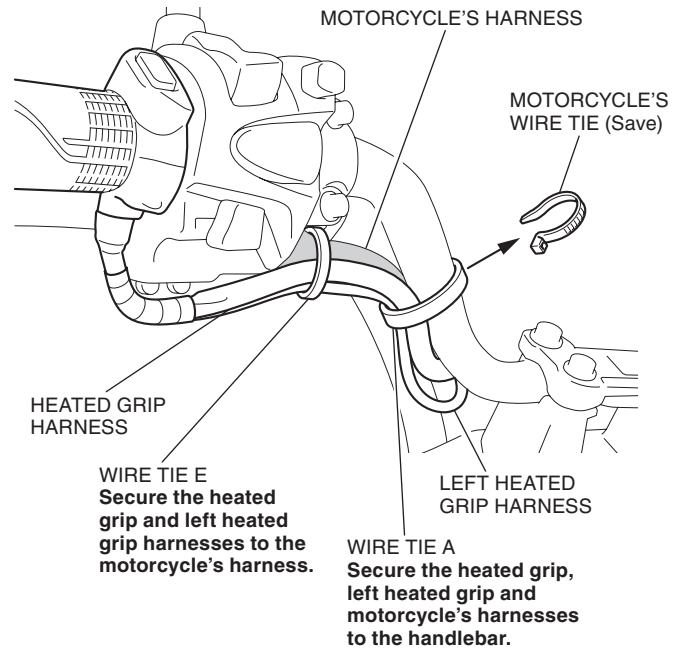

42. Connect each harness as shown.

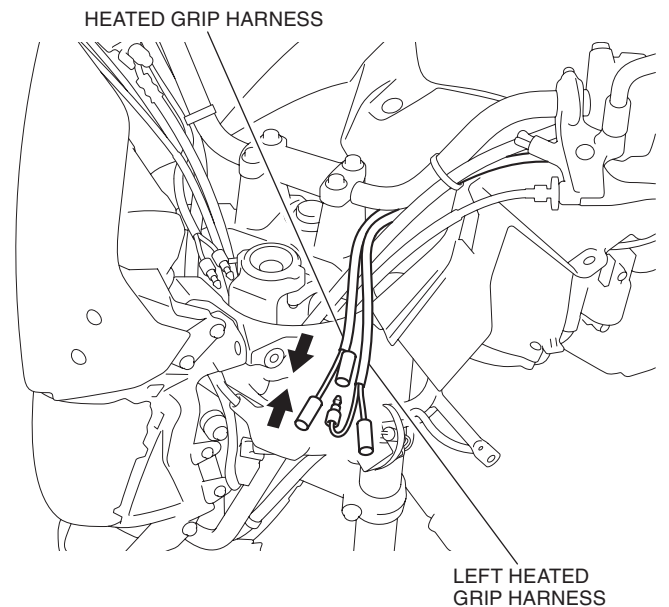



43. Route and connect the right heated grip harness as shown.

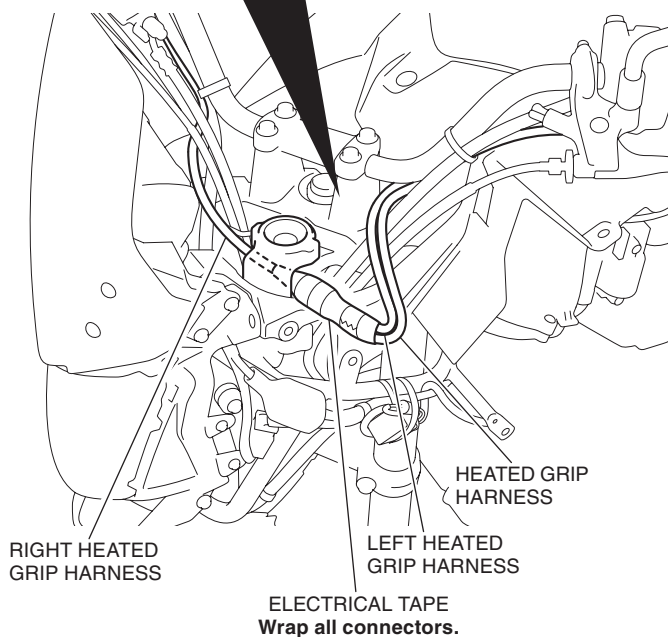
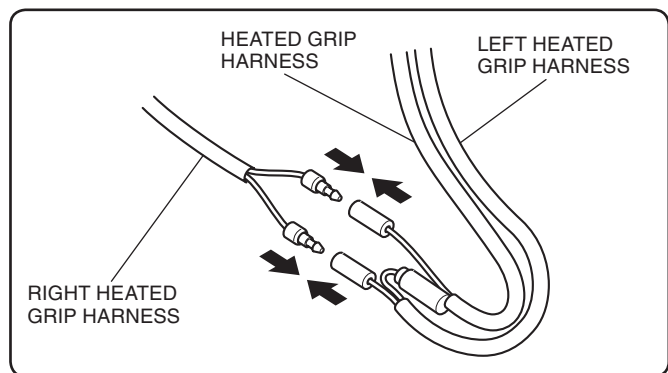

44. Secure each harness with the wire ties as shown.

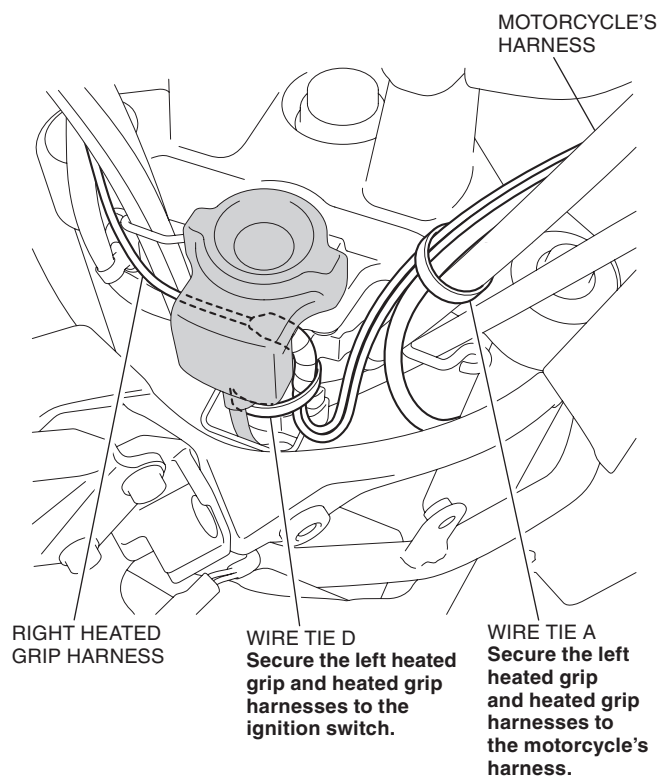

45. Secure the right heated grip harness as shown.

- **Open and close the throttle and confirm that there is no tightness of the heated grip harness.**

<NC700X>

MOTORCYCLE'S WIRE TIE (Reuse)  
Secure the right heated grip harness together with the motorcycle's harness.

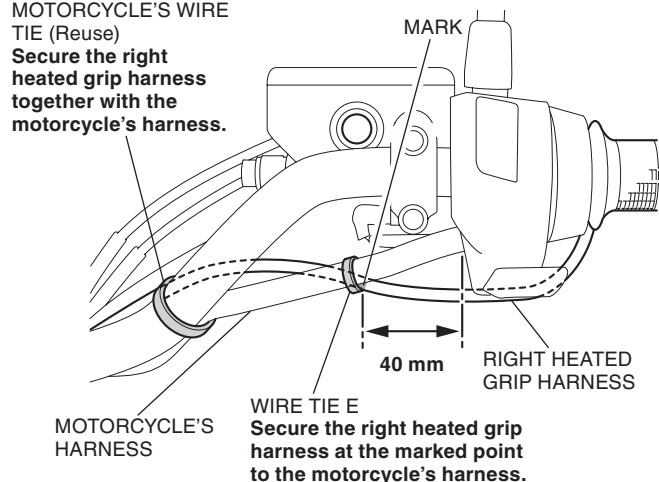

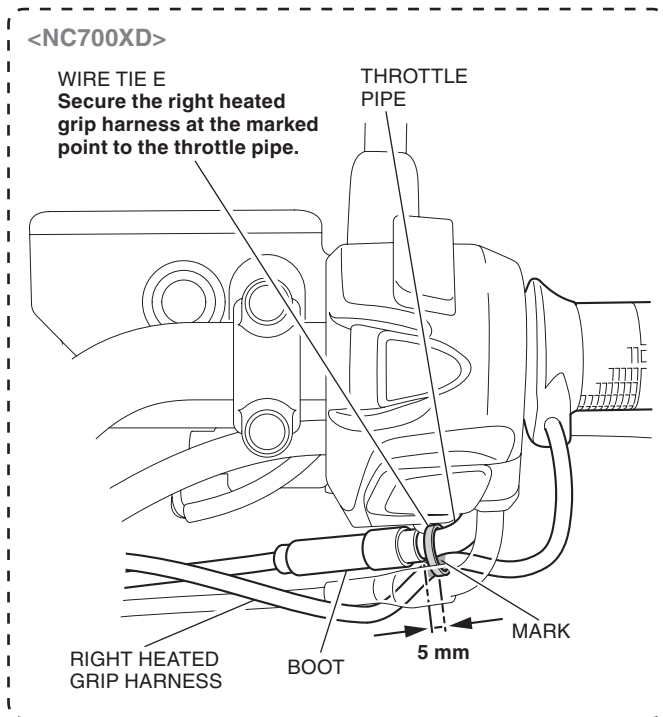

46. Check each harness for sufficient freeplay.
- **Move the handlebar right and left and check that the harnesses are not pinched by the neighboring components and that they are not pulled taut.**
47. Install the motorcycle's parts in the reverse order of removal.
- **Confirm that the harness is not caught or too tight.**

## DEALER TROUBLESHOOTING

- Stop the engine and turn the ignition switch OFF when you check the parts and circuits other than those of the heated grips.

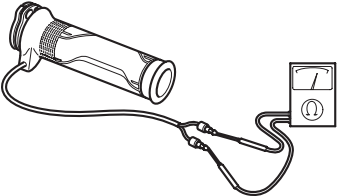
Symptom	Check
Heated grip does not operate; • Faulty heated grip • Faulty heated grip coil • Blown fuse • Open or short circuit in heater harness • Faulty heater switch	<ol style="list-style-type: none"> <li>1. Check whether wires and cables (terminals and connectors) are connected securely.</li> <li>2. Heated grip inspection            Check for resistance between the terminals.            ➔ Standard:            Right : 2.2 ohms +/- 10%            Left : 2.2 ohms +/- 10%            </li> <li>3. Heater harness inspection:            Check for continuity.</li> <li>4. If no abnormality is found after the above checks 1, 2, and 3, but the heated grip still does not operate properly, replace the heater switch with a new one.           <ul style="list-style-type: none"> <li>• It is hard to check the switch with ordinary inspection methods (for continuity, voltage, etc.) because it contains an integrated circuit.</li> </ul> </li> </ol>